

ADJOINS SHEET 6

ADJOINS SHEET 12

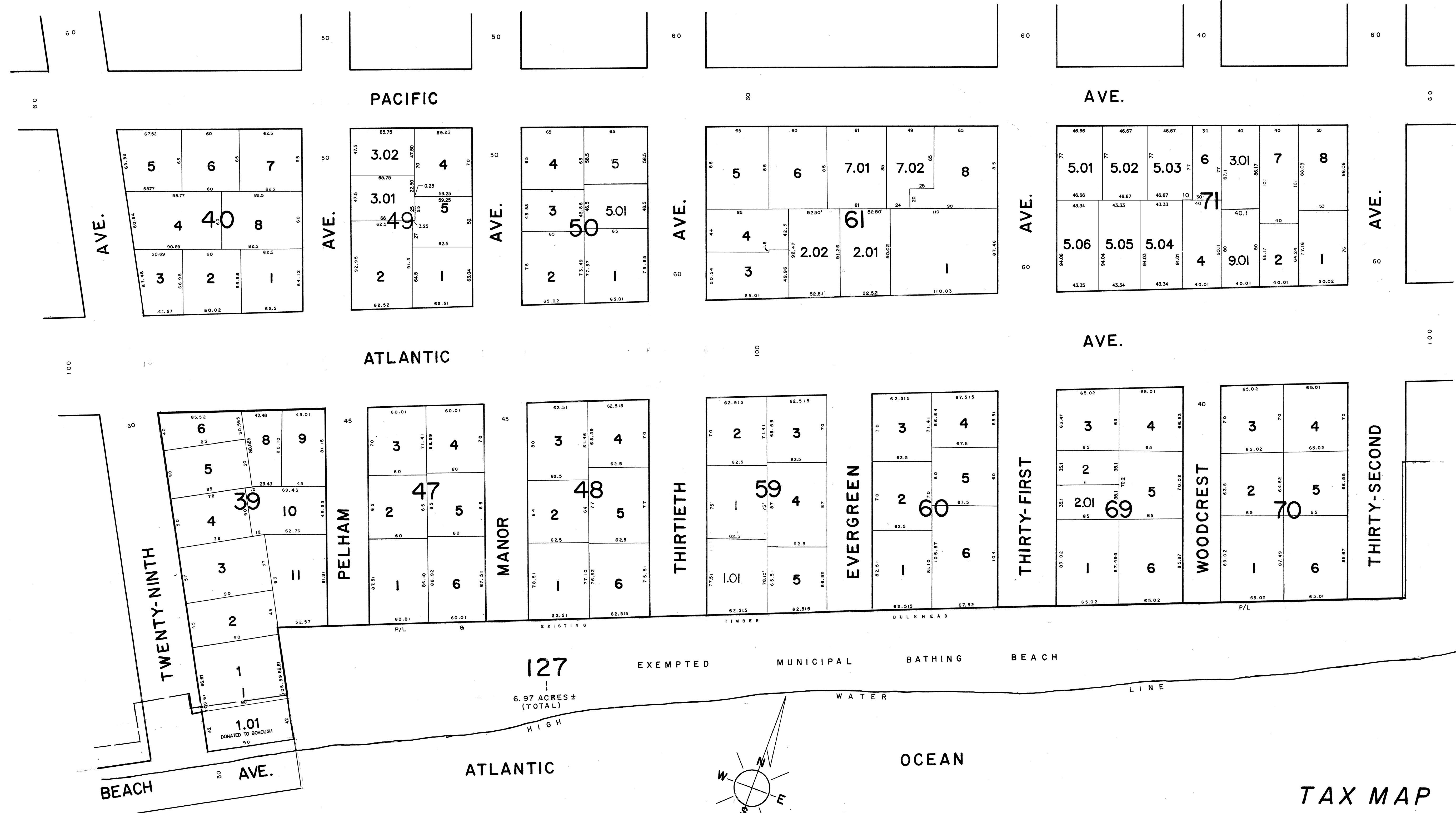

DATE	REVISION	BY
5/2017	BLOCK 39, LOT 1.01	PKR DC
5/2010	BLOCK 39, CONSOLIDATE LOTS 7 AND 8	M.E.
5/2005	BLOCK 49, LOT 1 & 5, PER ASSESSOR	ADR
7-31-02	BLOCK 71, SUBDIVISION LOT 5	CBA
5/2001	BLOCK 49, LOT 3, PER ASSESSOR	CBA
5/2001	BLOCK 61, LOT 7, SUBDIVISION	CBA
7-1-93	BLOCK 49 PER ASSESSOR	CBA
12-1-92	GENERAL - AS PER N.J. DEPT. OF TREASURY	CBA
10-17-90	BLOCK 50, LOT 5, MIN. SUBDIVISION	DECO

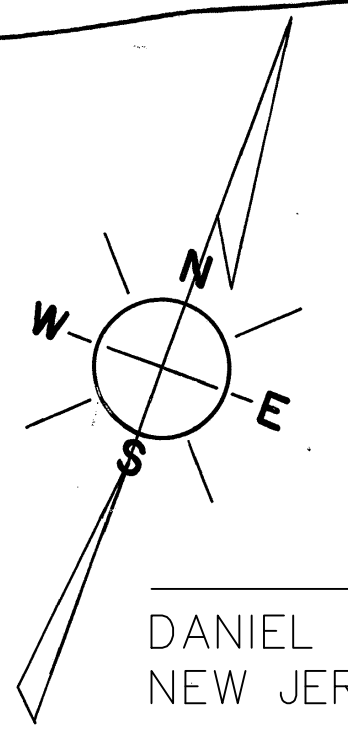

ELECTRONIC COPY
 DANIEL J. PONZIO SR.
 NEW JERSEY LIC. #GS37603
 TO SHOW CONDITIONS AS OF JUNE, 2017

NEW JERSEY DEPARTMENT OF THE TREASURY
 DIVISION OF TAXATION
 PUBLIC UTILITY TAX BUREAU
 APPROVED AS A TAX MAP PURSUANT TO THE
 PROVISIONS OF CHAPTER 175, LAWS OF 1915, ETC.
 FOR THE DIRECTOR, DIVISION OF TAXATION.
 BY *J. H. Thomas, Jr., E.L.L.S.*
 L.L.C. #5009 STAFF SUPERVISOR
 DATE **DEC 8 1971** SERIAL No. **491**

TAX MAP
 OF THE
BOROUGH OF LONGPORT
ATLANTIC COUNTY, N.J.
 SCALE: 1" = 50'
 REV. JAN. 1984
 J. THOMAS WOOD, JR., PE & L.S. NO. 8139
 GEORGE E. SCHILLING, L.S. NO. 16198
 421 GUARANTEE TRUST BLDG.
 ATLANTIC CITY, N.J.