

ADJOINS SHEET 10

ADJOINS SHEET 7

ADJOINS SHEET 6

ADJOINS SHEET 13

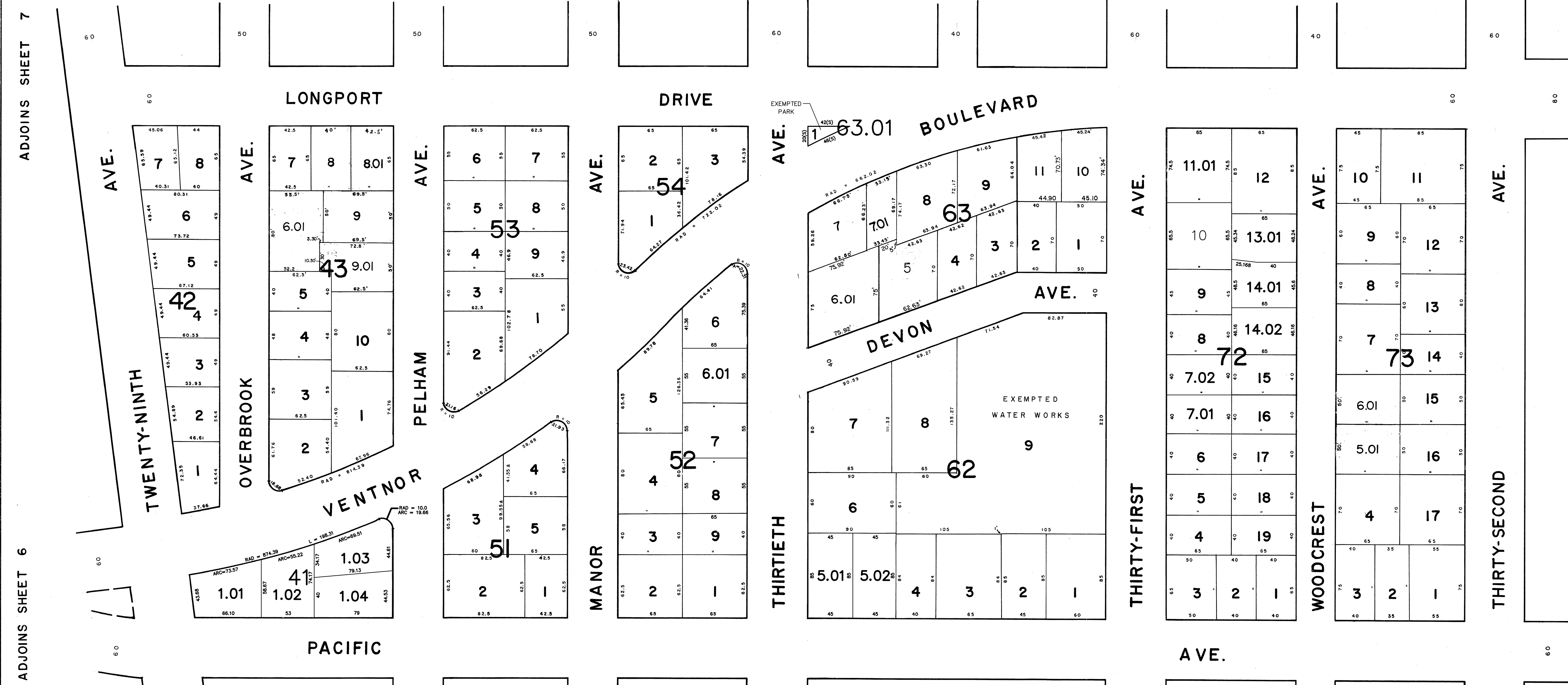

DATE	REVISION	BY	DESCRIPTION
5/2017			BLOCK 72 LOT 10 RENUMBERED PER DC
2/2007			BLOCK 41 LOT 1 - SUBDIVISION M. DNO
5/2005			BLOCK 52 LOTS 6 & 6.01 PER ASSESSOR M. DNO
5/2005			BLOCK 72 LOTS 13 & 14 PER ASSESSOR M. DNO
5/2005			BLOCK 52 LOTS 7 & 8 PER ASSESSOR M. DNO
5/2001			BLOCK 72 LOTS 10, 11, SUBDIVISION CBA
5/2001			BLOCK 62, LOT 5, SUBDIVISION CBA
5/2001			BLOCK 63.01, LOT 1, PER ASSESSOR CBA
7-1-93			BLOCK 73 PER ASSESSOR CBA
7-1-93			BLOCK 43 & 63 PER ASSESSOR CBA
5/2/00			BLOCK 72 PER ASSESSOR CBA
12/26/99			BLOCK 63 PER ASSESSOR CBA
10/7/80			BLOCK 43 L. 6.601, 9.01 MIN. SUBD DECO
10/7/80			BLOCK 72 LOT 11 MIN. SUBD DECO
10/7/80			BLOCK 63, LOT 5, 6 MIN. SUBD DECO
2/2010			BLOCK 72 SUBDIVIDE LOT 7 M. DNO

ELECTRONIC COPY  
 DANIEL J. PONZIO SR.  
 NEW JERSEY LIC. #GS37603  
 TO SHOW CONDITIONS AS OF JUNE, 2017

ADJOINS SHEET

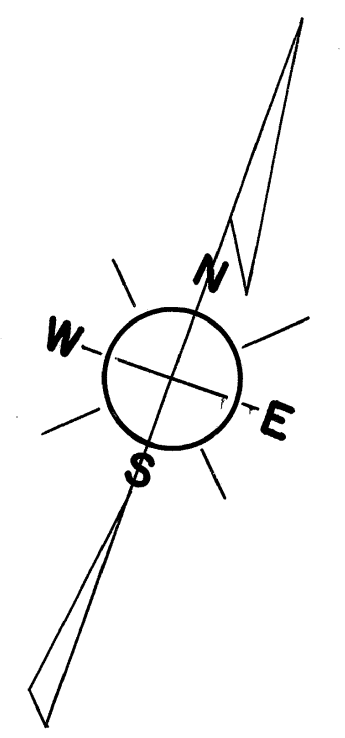

DECO 1989 REVISIONS

NEW JERSEY DEPARTMENT OF THE TREASURY  
 DIVISION OF TAXATION  
 PUBLIC UTILITY TAX BUREAU  
 APPROVED AS A TAX MAP PURSUANT TO THE  
 PROVISIONS OF CHAPTER 175, LAWS OF 1964, P.L.  
 FOR THE DIRECTOR, DIVISION OF TAXATION.  
 BY *[Signature]* P.E. & L.S.  
 L.L.C. #5005 STATE SUPERVISOR  
 DATE DEC 8 1970 SERIAL No. 439

**TAX MAP**  
 OF THE  
**BOROUGH OF LONGPORT**  
**ATLANTIC COUNTY, N.J.**  
 SCALE: 1" = 50'  
 1970  
 REV. JAN. 1984  
 J. THOMAS WOOD, JR., P.E. & L.S. NO. 8139  
 GEORGE E. SCHILLING, L.S. NO. 16198  
 421 GUARANTEE TRUST BLDG.  
 ATLANTIC CITY, N.J.